

1 CONSTRUCTION DETAIL  
9.6 3/4" = 1'

- 1) Vegetation
- 2) Soprafloor growing medium (type X or L)
- 3) Sopradrain 10-G
- 4) Microfab
- 5) Concrete, wood, or steel curb
- 6) Gravel or paver
- 7) Cap sheet membrane
- 8) Base sheet membrane
- 9) Primer
- 10) Polyethelene or stainless steel flashing with Sopramstic Alu sealant secured into Quad-Lock plastic ties as shown
- 11) Quad-Deck Concrete floor minimum slope to drain = 3°
- 12) Quad-Deck Panel
- 13) Ceiling finish (drywall)
- 14) Drain

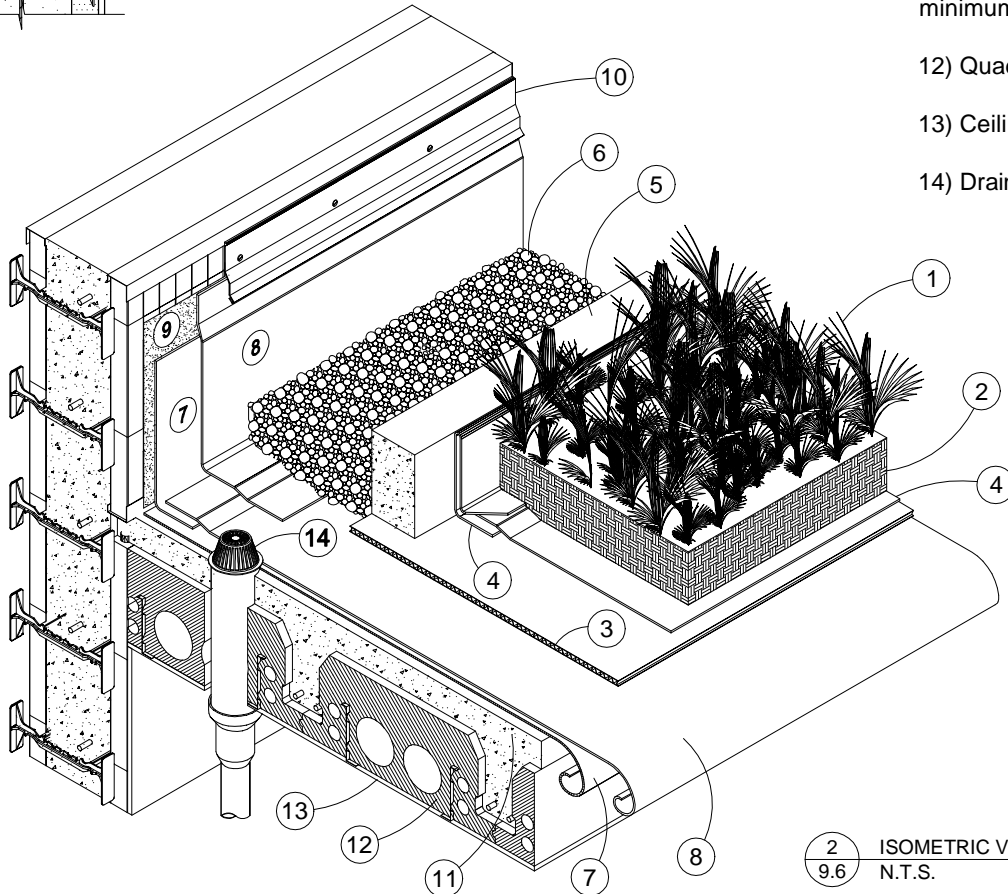

2 ISOMETRIC VIEW  
9.6 N.T.S.

# QUAD-LOCK<sup>®</sup> BUILDING SYSTEMS

Quad-Lock Building Systems Ltd.  
7398 - 132nd Street  
Surrey, BC V3W 4M7  
Canada

888.711.5625 - Toll Free  
604.590.3111  
604.590.8412 - fax  
www.quadlock.com

## QUAD-DECK GREEN ROOF

DATE:	2006-04-25	SCALE:	AS SHOWN
REVISION NO.:	R-02	PROJECT:	N/A
REVISION DATE:	2006-05-09	CUSTOMER:	N/A
DRAWN BY:	Z. PROSTRAN	APPROVED BY:	
			DRAWING NO: <b>9.6</b>

IT IS THE RESPONSIBILITY OF THE USER TO COMPLY WITH ALL APPLICABLE REGULATIONS AND BUILDING CODE REQUIREMENTS CONCERNING THE USE OF THESE PRODUCTS.  
IT IS FURTHER THE RESPONSIBILITY OF THE USER TO RESEARCH AND UNDERSTAND SAFE METHODS OF USE AND HANDLING OF THESE PRODUCTS.