

## R-22 WIDE WALL CONFIGURATIONS

WIDE WALL CONFIGURATION	WALL WIDTH <b>W</b>	WALL CAVITY <b>C</b>
4" Black Tie + Tie Extender	20 <sup>1</sup> / <sub>4</sub> " (514mm)	15 <sup>3</sup> / <sub>4</sub> " (400mm)
6" Blue Tie + Tie Extender	22 <sup>1</sup> / <sub>4</sub> " (565mm)	17 <sup>3</sup> / <sub>4</sub> " (451mm)
8" Yellow Tie + Tie Extender	24 <sup>1</sup> / <sub>4</sub> " (616mm)	19 <sup>3</sup> / <sub>4</sub> " (502mm)
10" Green Tie + Tie Extender	26 <sup>1</sup> / <sub>4</sub> " (667mm)	21 <sup>3</sup> / <sub>4</sub> " (552mm)
12" Red Tie + Tie Extender	28 <sup>1</sup> / <sub>4</sub> " (718mm)	23 <sup>3</sup> / <sub>4</sub> " (603mm)

TOP OF WALL FINISH  
CUT KNOBS OFF  
PLACE 1x4 CLEATS @ 48" O.C.  
FASTEN TO METAL TRACK AS SHOWN

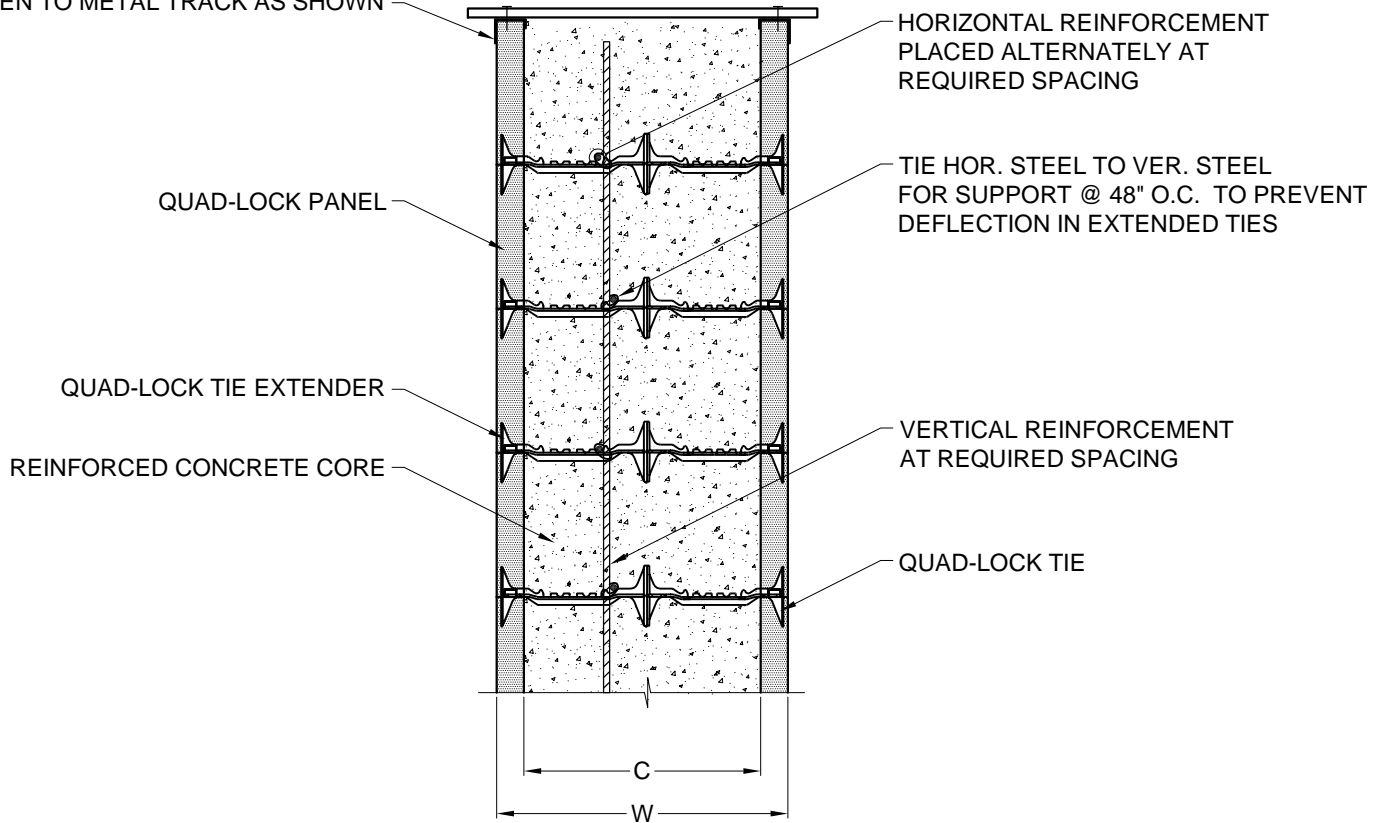

1 CONSTRUCTION DETAIL  
9.5 3/4" = 1'

**QUAD-LOCK**® BUILDING SYSTEMS

Quad-Lock Building Systems Ltd.  
7398 - 132nd Street  
Surrey, BC V3W 4M7  
Canada

888.711.5625 - Toll Free  
604.590.3111  
604.590.8412 - fax  
www.quadlock.com

DUE TO VARIANCES IN LOCAL CODES, CONSTRUCTION PRACTICES AND REQUIREMENTS ALL DETAILS SHALL BE CONSTRUCTED IN ACCORDANCE WITH SUCH LOCAL CODES, CONSTRUCTION PRACTICES, AND REQUIREMENTS REGARDLESS OF CONSTRUCTION DETAIL SHOWN IN DRAWING. QUAD-LOCK BUILDING SYSTEMS LTD. RESERVES THE RIGHT TO CHANGE INFORMATION SHOWN WITHOUT NOTICE.

## QUAD-LOCK WIDE WALLS

DATE:	2006-03-23	SCALE:	3/4" = 1'-0"
REVISION NO.:	R-01	PROJECT:	N/A
REVISION DATE:	2006-03-29	CUSTOMER:	N/A
DRAWN BY:	Z. PROSTRAN	APPROVED BY:	D. J. BENNION
			DRAWING NO.:
			9.5