

1. EXTERIOR FINISH AS SPECIFIED
2. RAFTER AS SPECIFIED
3. 2x4 CONTINUOUS - FASTEN TO JACK RAFTERS
4. FASCIA BOARD
5. GUTTER SYSTEM BY OTHERS
6. WALL SHEATHING
7. ROOFING AS SPECIFIED
8. FASTEN RAFTER TO WALL VIA BOLTED 2x4 & 3/4" PLYWOOD
9. FURRING CHANNELS FOR ROOFING ATTACHMENT
10. STEEL RAFTERS AS SPECIFIED
11. METAL ROOFING AS SPECIFIED
12. FASTEN CEILING FINISH TO FURRING CHANNELS
13. QUAD-LOCK WIRE TOP TIE
14. INTERNAL P.T. SILL PLATE W/ J/BOLTS CAST IN PLACE
15. REMOVE CONTINUOUS STRIP OF FOAM
16. VERTICAL REINFORCEMENT AS SPECIFIED
17. HORIZONTAL REINFORCEMENT AS SPECIFIED
18. REINFORCED CONCRETE CORE
19. QUAD-LOCK TIE REGULAR 2.25" PANEL
20. QUAD-LOCK TIE (8" YELLOW SHOWN)
21. FASTEN INTERIOR FINISH TO QUAD-LOCK TIE FLANGES

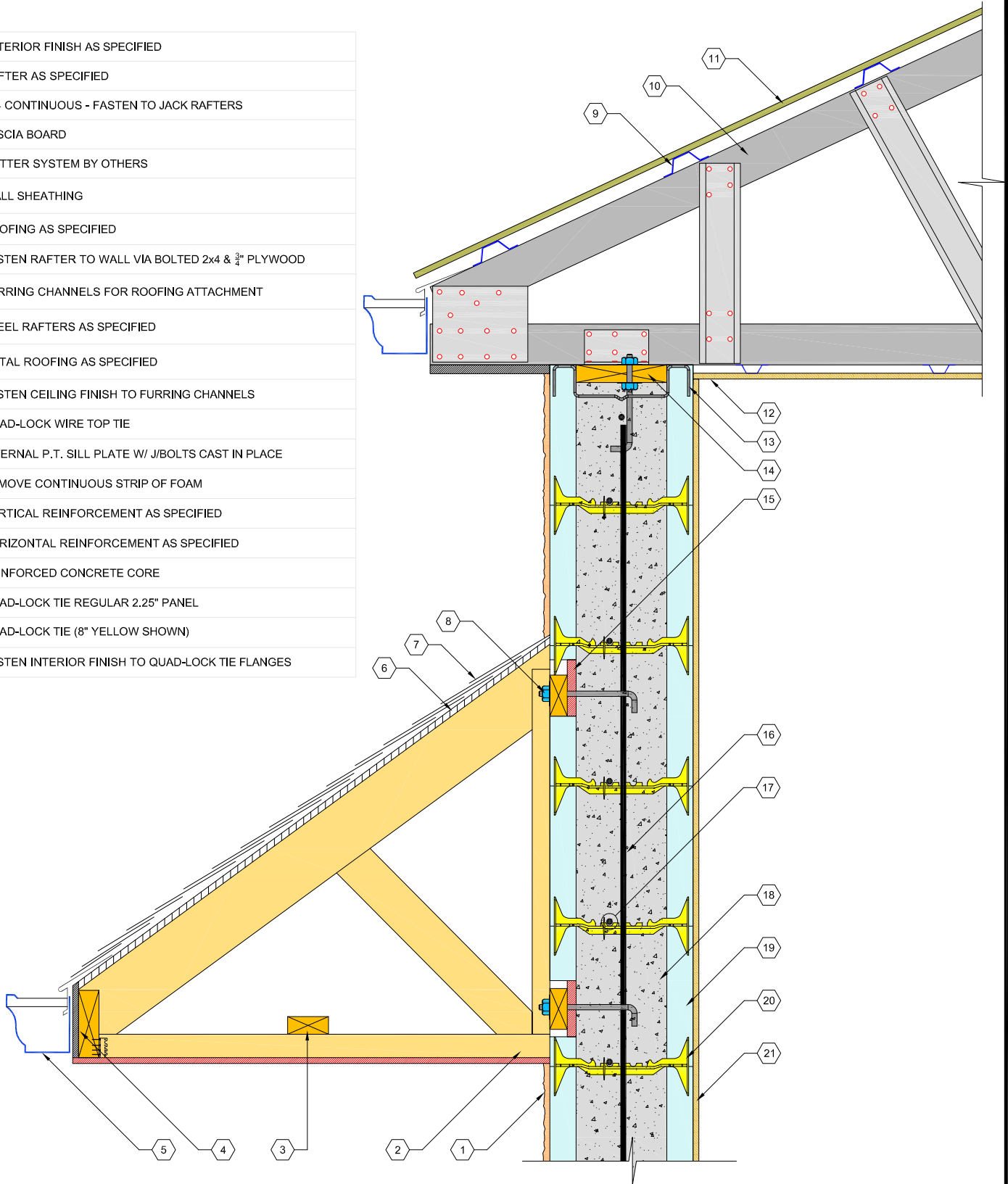

**QUAD-LOCK**  
Building Systems Ltd.

Quad-Lock Building Systems Ltd.  
7398 - 132nd Street  
Surrey, BC V3W 4M7  
Canada

888.711.5625 - Toll Free  
604.590.3111  
604.590.8412 - fax  
www.quadlock.com

IT IS THE RESPONSIBILITY OF THE USER TO COMPLY WITH ALL APPLICABLE REGULATIONS AND BUILDING CODE REQUIREMENTS CONCERNING THE USE OF THESE PRODUCTS.  
IT IS FURTHER THE RESPONSIBILITY OF THE USER TO RESEARCH AND UNDERSTAND SAFE METHODS OF USE AND HANDLING OF THESE PRODUCTS.

## ROOF CONNECTION DETAIL

DATE:	2009-01-21	SCALE:	NOT TO SCALE
REVISION NO.:	R-02	PROJECT:	
REVISION DATE:	2009-07-10	CUSTOMER:	
DRAWN BY:	Z. PROSTRAN	APPROVED BY:	H.M.K. & D.J.B.
			DRAWING NO.:
			QL-503