

1. ZERO COMPACTION SAND OR GRAVEL
2. UNDER SLAB INSULATION
3. SLAB ON GRADE - REINFORCEMENT AS SPECIFIED
4. WATER
5. LINER AS SPECIFIED
6. REINFORCED BASE COAT
7. QUAD-LOCK WIRE TOP TIE
8. QUAD-LOCK TRACK - REMOVE PANEL KNOBS AND INSERT AS SHOWN
9. TOP OF WALL REINFORCEMENT
10. TILES AS SPECIFIED
11. GROUT
12. QUAD-LOCK REGULAR 2.25" PANEL
13. QUAD-LOCK TIE (8" YELLOW SHOWN)
14. VERTICAL REINFORCEMENT AS SPECIFIED
15. HORIZONTAL REINFORCEMENT AS SPECIFIED
16. PEEL&STICK WATER PROOFING OR SIM.
17. OPTIONAL BACKFILL PROTECTION - DIMPLEBOARD OR SIM.
18. COMPACTED FILL
19. GEO-TEXTILE FABRIC (OPTIONAL)
20. DRAIN ROCK
21. PERIMETER DRAIN
22. FOOTING STRIP REINFORCEMENT AS SPECIFIED
23. QUAD-LOCK TRACK
24. FOOTING STRIP - SEE STRUCTURAL DETAILS FOR SIZE AND REINF.
25. ALTERNATE DOWELS AND EXTEND INTO WALL AS SPECIFIED

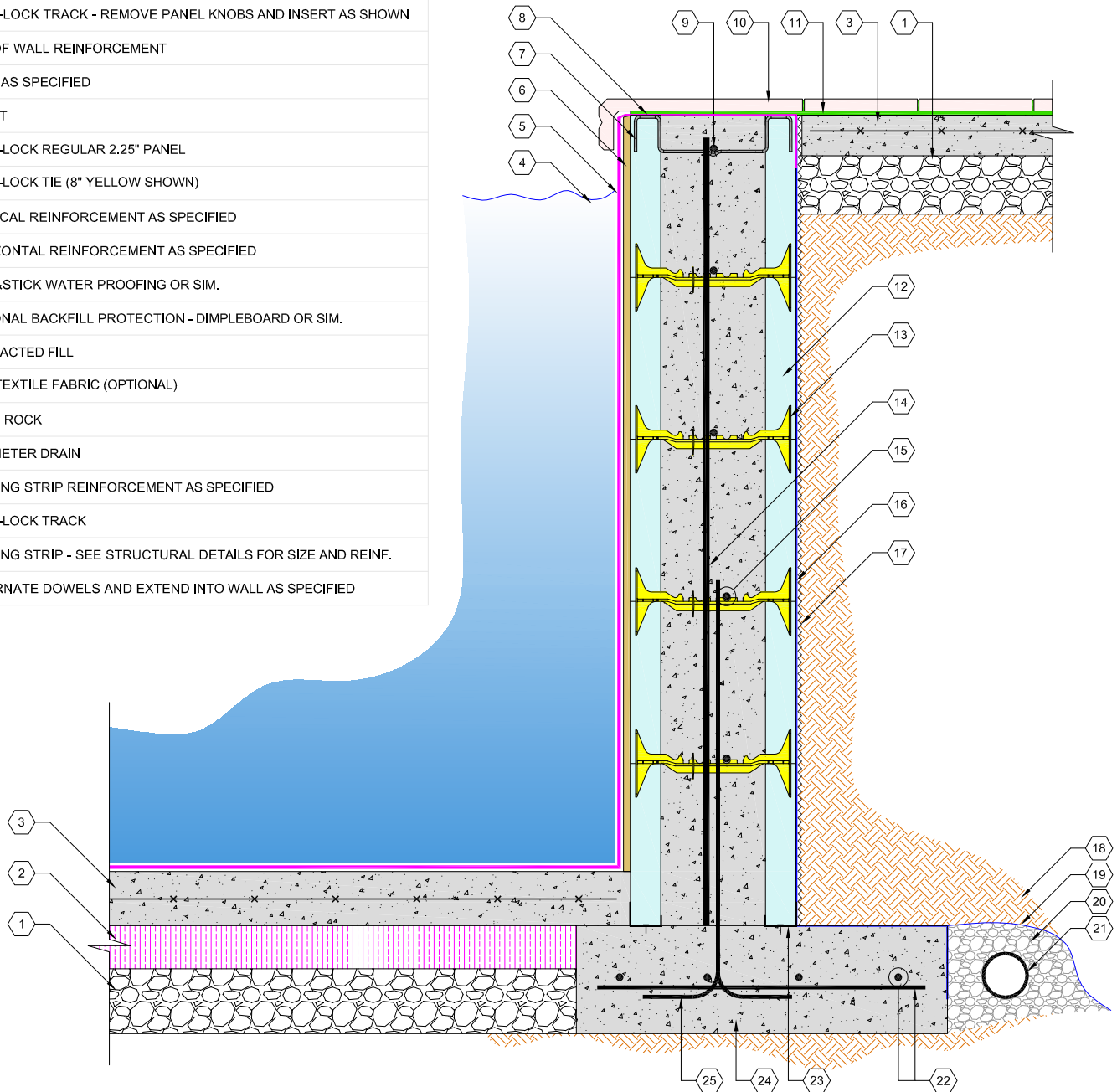

QUAD-LOCK
Building Systems Ltd.

Quad-Lock Building Systems Ltd.
7398 - 132nd Street
Surrey, BC V3W 4M7
Canada

888.711.5625 - Toll Free
604.590.3111
604.590.8412 - fax
www.quadlock.com

IT IS THE RESPONSIBILITY OF THE USER TO COMPLY WITH ALL APPLICABLE REGULATIONS AND BUILDING CODE REQUIREMENTS CONCERNING THE USE OF THESE PRODUCTS.

IT IS FURTHER THE RESPONSIBILITY OF THE USER TO RESEARCH AND UNDERSTAND SAFE METHODS OF USE AND HANDLING OF THESE PRODUCTS.

SWIMMING POOL DETAIL

DATE: 2009-01-21

SCALE: NOT TO SCALE

REVISION NO: R-02

PROJECT:

REVISION DATE: 2009-07-10

CUSTOMER:

DRAWN BY: Z. PROSTRAN

APPROVED BY:

H.M.K. & D.J.B.

DRAWING NO:

QL-108